

AQUAPEEL - Solutions

Step 1 Interface
PEEL+ Solution (in use)

Timer
05
10:00

Vacuum Level
Adjustable from 1-10
05
VAC

Step 2 Interface
SEBO+ Solution (inactive)

START/STANDBY
START

AQUAPEEL Interface
M1 M2 M3

Preset Configuration
Preset Options for Parameters and Timer



PEEL+ / SEBO+

Step 1
Upward strokes

Step 2
Downward strokes

Step 3
Outward strokes

Step 4
Outward strokes

REJUVE+

Step 1
Dabbing around the mouth

Step 2
Dabbing on both cheeks

Step 3
Dabbing around the eyes

Step 4
Dabbing on the forehead

*When starting treatment for AQUAPEEL, ensure to test for effective solution distribution by adjusting the knob to level 10 momentarily.

PARAMETERS	Solution 1/PEEL+	Solution 2/SEBO+	Solution 3/REJUVE+
TIME	5-7 minutes	5-7 minutes	5-7 minutes
VACUUM LEVEL	4-6	4-6	4-6
KNOB LEVEL	5-6	5-6	5-6

*Cleaning required after SEBO+ and REJUVE+. Refer to the AQUAPEEL Cleaning section of this quick manual.

AQUAPEEL - Cleaning

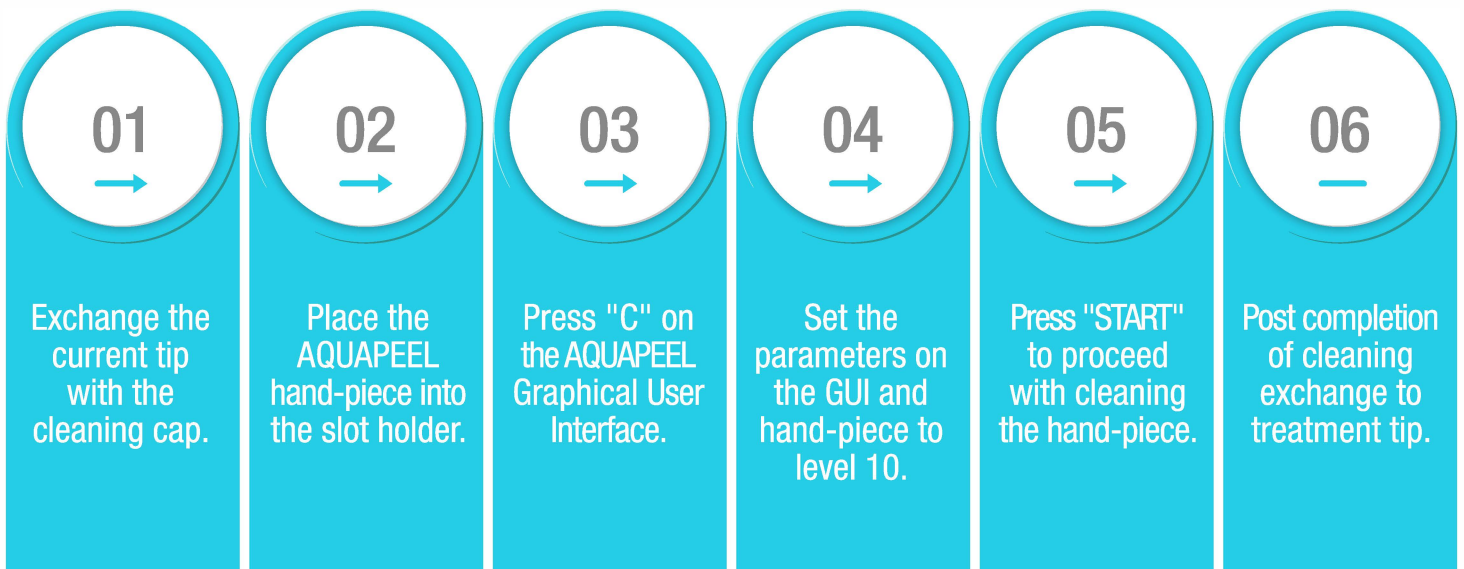
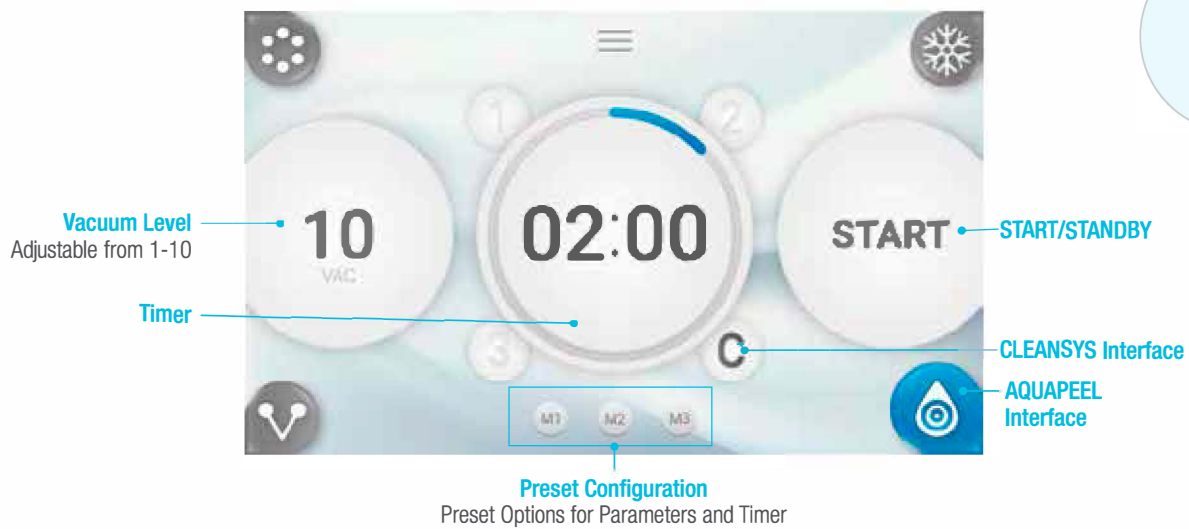

*Cleaning is conducted after Solution 2 (SEBO+) and Solution 3 (REJUVE+).

AQUAPEEL

Contraindications

- Pregnancy or when breastfeeding
- Open wounds, abrasions, and inflammation of the face
- Severe or cystic acne
- Allergies to AQUAPEEL Solutions that may react during treatment

Precautions for Patient

- Type 1 Diabetes
- Skin conditions caused by autoimmune diseases, cancer, and Herpes Simplex
- Oral, topical, or invasive treatments to skin within varied periods prior to receiving the AQUAPEEL procedure
- Ensure to conduct a patch test on the skin before using acid-based products. Allow 24-48 hours to monitor if an irritation occurs

Precautions for Procedure

- Have patient remove makeup or other facial applications by a thorough face wash to prevent obstruction of solutions used during the AQUAPURE treatment.
- Clean the AQUAPEEL hand-piece twice after SEBO+ and REJUVE+ procedures and at the end of each day of operations to prevent system buildup of solution ingredients during the AQUAPURE treatment.
- Post procedure, the following side effects and risks from receiving the AQUAPEEL treatment may include redness, slight tightness, and swelling in treated areas which may last from a few hours to a couple of days following treatment.
- Do not use the equipment without prior training, meeting qualifications or permission to operate by an authorized CLUEDERM representative.
- Check the patient's medical history for health assessments (allergic reactions, both internal and external health disorders, and injuries that might react negatively during the AQUAPURE treatment.)
- Make sure to adjust the levels based on the patient's skin sensitivity and procedure parameters.
- Patients must wear eye protection to avoid contact with PEEL+, SEBO+, REJUVE+, ampoule, and ultrasound gel during the AQUAPURE treatment. (Cotton pads are recommended)

ELECTROPORATION

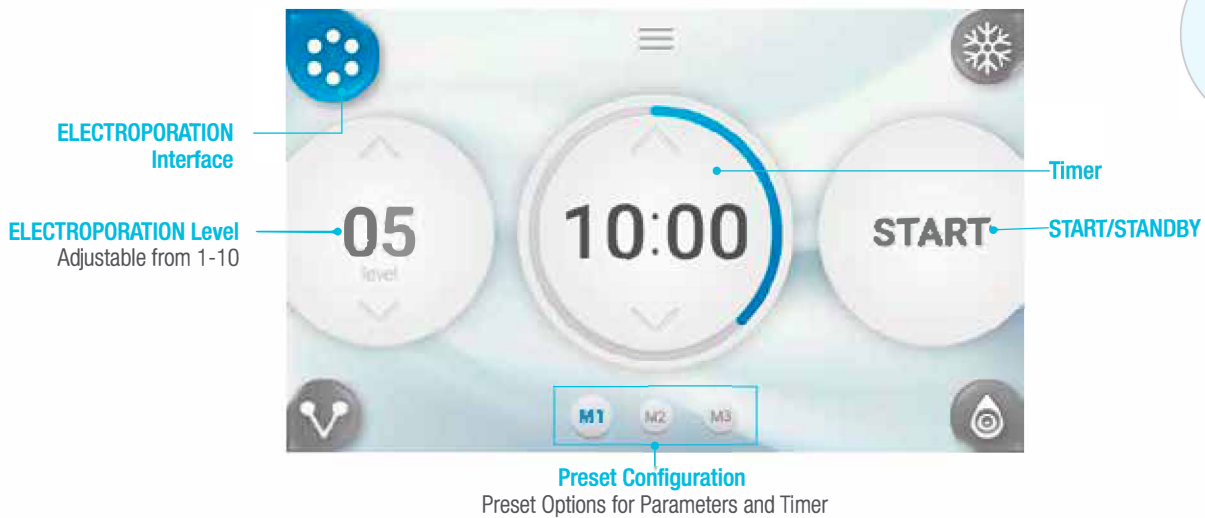

ELECTROPORATION

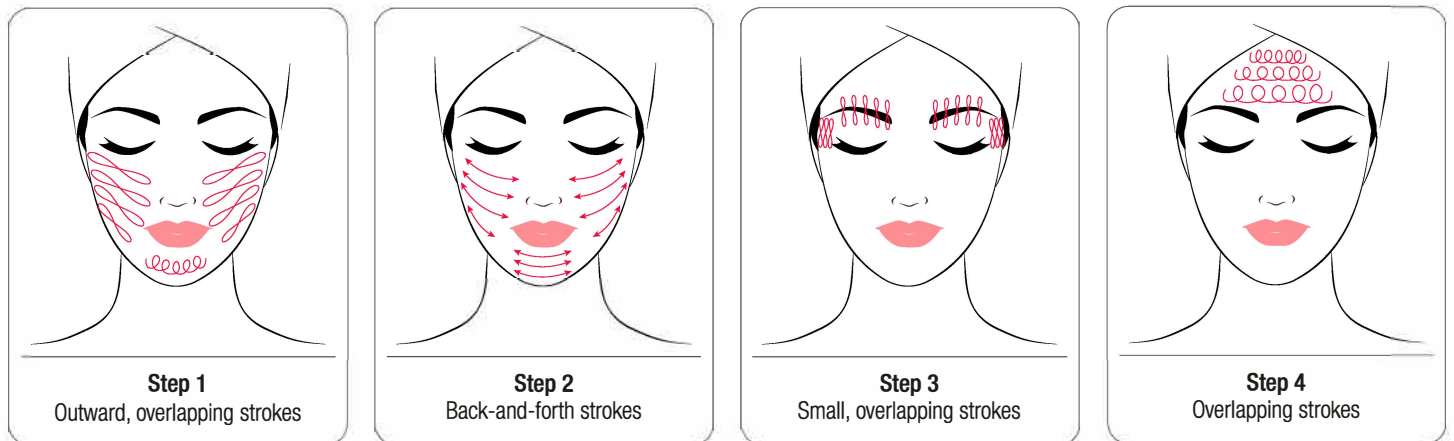

PARAMETERS

TIME
LEVEL

ELECTROPORATION

5-7 minutes
3-4

ELECTROPORATION

Contraindications

- Metal implants such as pacemakers, defibrillators, and pins
- Pregnancy or when breastfeeding
- Severe or cystic acne

Precautions for Patient

- Epilepsy and seizures
- Surgical procedures within 40 days
- Type 1 Diabetes
- Skin conditions caused by autoimmune diseases, cancer, and Herpes Simplex

Precautions for Procedure

- Using the ELECTROPORATION hand-piece is strictly prohibited if the patient has both internal and external metal implants.
- If residue of solutions used during the AQUAPEEL procedure is still present on the patient's face, then ELECTROPORATION cannot work effectively.
- Practitioners must notify patients that symptoms may include temporary redness in the treated areas but will dissipate within 2-3 days.
- Do not use the equipment without prior training, meeting qualifications or permission to operate by an authorized CLUEDERM representative.
- Check the patient's medical history for health assessments (allergic reactions, both internal and external health disorders, and injuries that might react negatively during the AQUAPURE treatment.)
- Make sure to adjust the levels based on the patient's skin sensitivity and procedure parameters.
- Patients must wear eye protection to avoid contact with PEEL+, SEBO+, REJUVE+, ampoule, and ultrasound gel during the AQUAPURE treatment. (Cotton pads are recommended)

MICRO-CURRENT



MICRO-CURRENT

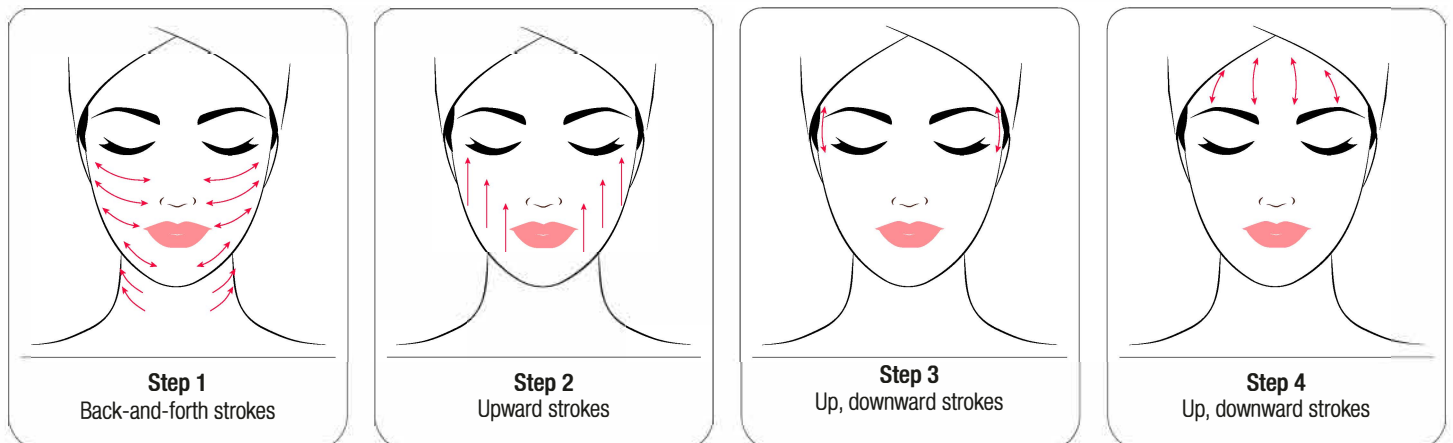

PARAMETERS

TIME
LEVEL

MICRO-CURRENT

5-7 minutes
3-4

*Use ampoule or ultrasound gel as an agent between the hand-piece and skin for procedure.

MICRO-CURRENT

Contraindications

- Metal implants such as pacemakers, defibrillators, and pins
- Pregnancy or when breastfeeding
- Facial nerve tumors

Precautions for Patient

- Epilepsy and seizures
- Electromagnetic hypersensitivity
- Cardiovascular diseases such as heart attacks and strokes
- Fever

Precautions for Procedure

- Avoid applying the MICRO-CURRENT hand-piece in one single area for prolonged periods of time. The hand-piece can generate output pulses of up to 650 volts which can result in burns.
- Electromagnetic stimulation of the MICRO-CURRENT hand-piece should not be applied on arteries, nerves, areas around the eyes, neck, or mouth (laryngeal and pharyngeal muscle spasms may occur), near lesions, rashes, or inflamed skin.
- Due to the probability that some patients might be hypersensitive to the electromagnetic stimulation of the MICRO-CURRENT, it is advisable to adjust levels suitable to the patient.
- Notify the patients that symptoms may include nausea and drowsiness, though rare in occurrence.
- Do not use the equipment without prior training, meeting qualifications or permission to operate by an authorized CLUEDERM representative.
- Check the patient's medical history for health assessments (allergic reactions, both internal and external health disorders, and injuries that might react negatively during the AQUAPURE treatment.)
- Make sure to adjust the levels based on the patient's skin sensitivity and procedure parameters.
- Patients must wear eye protection to avoid contact with PEEL+, SEBO+, REJUVE+, ampoule, and ultrasound gel during the AQUAPURE treatment. (Cotton pads are recommended)

COOLING/HEATING

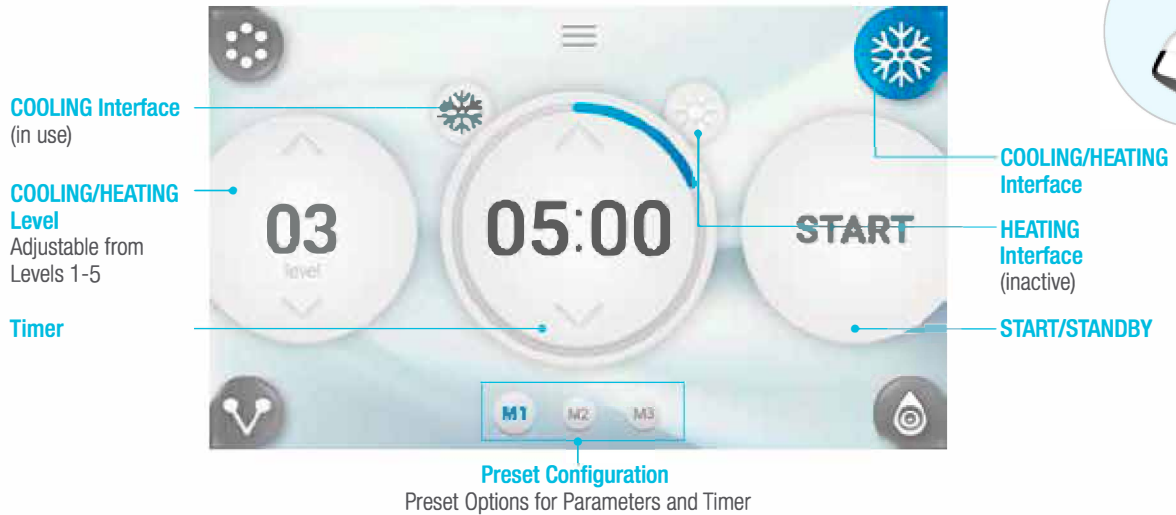

COOLING/HEATING

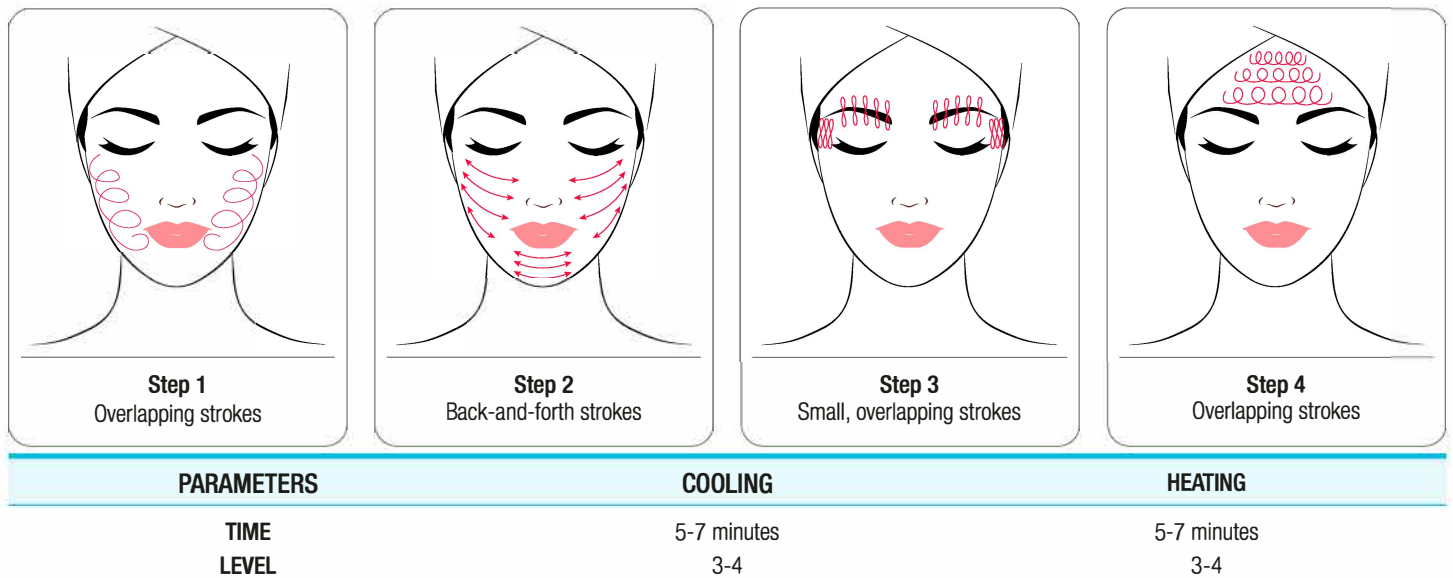

*Use ampoule or ultrasound gel as an agent between the hand-piece and skin for procedure.

COOLING/HEATING

Contraindications

- Open wounds, abrasions, and inflammation of the face
- Pregnancy or when breastfeeding
- Multiple Sclerosis (MS)

Precautions for Patient

- Cold sensitivity
- Skin conditions caused by autoimmune diseases, cancer, and Herpes Simplex
- Dermatitis or eczema
- Local facial areas of impaired circulation
- Surgical procedures done within 40 days
- Decreased sensation

Precautions for Procedure

- Avoid applying the COOLING/HEATING hand-piece in one single area for prolonged periods of time where patients may suffer from sensitivity to adjusted temperatures and impaired circulation.
- Do not apply the COOLING/HEATING hand-piece on facial areas where open and infected wounds, abrasions, and signs of inflammation are present.
- Adjust temperatures on the COOLING/HEATING hand-piece based on the patient's health condition such as multiple sclerosis and cold sensitivity.
- Do not use the equipment without prior training, meeting qualifications or permission to operate by an authorized CLUEDERM representative.
- Check the patient's medical history for health assessments (allergic reactions, both internal and external health disorders, and injuries that might react negatively during the AQUAPURE treatment.)
- Make sure to adjust the levels based on the patient's skin sensitivity and procedure parameters.
- Patients must wear eye protection to avoid contact with PEEL+, SEBO+, REJUVE+, ampoule, and ultrasound gel during the AQUAPURE treatment. (Cotton pads are recommended)

AQUAPURE by Skin Type

Healthy Skin

	PEEL+	SEBO+	REJUVE+	ELECTROPORATION	MICRO-CURRENT	COOLING	HEATING
TIME	5	5	5	5	5	X	5
LEVEL	5	5	5	5	4	X	4

Anti-Aging

	PEEL+	SEBO+	REJUVE+	ELECTROPORATION	MICRO-CURRENT	COOLING	HEATING
TIME	5	3	8	5	8	X	5
LEVEL	4	4	5	3	4	X	3

Wrinkle Reduction

	PEEL+	SEBO+	REJUVE+	ELECTROPORATION	MICRO-CURRENT	COOLING	HEATING
TIME	7	X	8	5	5	X	5
LEVEL	5	X	5	3	4	X	3

Brightening

	PEEL+	SEBO+	REJUVE+	ELECTROPORATION	MICRO-CURRENT	COOLING	HEATING
TIME	7	4	8	5	3	3	3
LEVEL	5	5	5	4	4	3	3

Oily/Congested

	PEEL+	SEBO+	REJUVE+	ELECTROPORATION	MICRO-CURRENT	COOLING	HEATING
TIME	3	8	5	5	X	5	X
LEVEL	5	5	5	4	X	4	X

Acne Skin

	PEEL+	SEBO+	REJUVE+	ELECTROPORATION	MICRO-CURRENT	COOLING	HEATING
TIME	5	8	5	5	X	5	X
LEVEL	4	4	5	4	X	4	X

Sensitive Skin

	PEEL+	SEBO+	REJUVE+	ELECTROPORATION	MICRO-CURRENT	COOLING	HEATING
TIME	5	X	5	X	3	5	X
LEVEL	3	X	3	X	2	3	X