

# AQUAPURE

Smart Genuine Facial Care System



Go Pure  
Be Youth

## Table of Contents

### Introduction

1. Introduction of the AQUAPURE
2. AQUAPURE Hand-pieces
  - AQUAPEEL
  - ELECTROPORATION
  - MICRO-CURRENT
  - COOLING/HEATING
3. AQUASOLUTION Range
  - PEEL+
  - SEBO+
  - REJUVE+
  - CLEANSYS

### Precautions for Treatment

1. Contraindications
2. Preferred Patient Selection
3. Potential Side Effects
4. Precautions

### Operational Guideline

1. Graphical User Interface (GUI)

### Treatment

1. Preparation for Treatment
2. Treatment Steps & Parameters

# Introduction

## Introduction of the AQUAPURE



The AQUAPURE is a non-invasive, multifunctional facial care device that treats a variety of skin conditions in patients with diverse skin profiles. Each AQUAPURE Hand-piece works to promote skin tightness and rejuvenation with skin-nourishing solutions that delivers immediate results.

\*Individual results may vary based on the skin conditions concerned.

# Introduction

## AQUAPURE Hand-pieces



### AQUAPEEL

- Operates with Small and Large Treatment Tips for peeling skin to promote effective skin rejuvenation and prolonged hydration
- Utilizes a Cleaning Cap to prevent system buildup of previously used solutions
- Operates with PEEL+, SEBO+, REJUVE+, CLEANSYS



### ELECTROPORATION

- Helps penetrate the previously applied solutions into deep layers of the skin by transdermal motion
- \*Use any ampoule as an agent between the hand-piece and skin for procedure.



### MICRO-CURRENT

- Operates with Y-shaped, double rollers that conducts electromagnetic stimulation on the patient's face
- \*Use ampoule or ultrasound gel as an agent between the hand-piece and skin for procedure.



### COOLING/HEATING

- A flat, metal-surfaced hand-piece that relieves hypersensitivity and promotes absorption of nutrients previously applied during treatment
- \*Use ampoule or ultrasound gel as an agent between the hand-piece and skin for procedure.

## AQUASOLUTION Range



### PEEL+

Facilitates the thorough process of exfoliation, removing impurities like dead skin cells and blackheads for a successful treatment



### SEBO+

Helps the skin maintain a healthy balance between oily and moist tones for sebum dissolution



### REJUVE+

Promotes elasticity by inducing collagen and elastin regeneration, improving water retention to prevent moisture loss



### CLEANSYS

A primary cleaning agent formulated for an effective system maintenance procedure

# Precautions for Treatment

## Contraindications

Do not treat anyone with the following symptoms. This system is contraindicated for subjects with:

- Pregnancy or when breastfeeding
- Implanted electrical and metal devices
- Severe or cystic acne
- Skin allergies to AQUAPEEL's solutions that may react during treatment
- Open wounds, abrasions, and inflammation of the face
- Allergy to chemical peels

## Preferred Patient Selection

Patients who comply with the following requirements are preferred for yielding greater results:

- Overall healthy skin
- No wounds within the treatment area

\*The above are recommendations and not requirements.

## Potential Side Effects

- Patients may experience varied tolerance levels of pain and discomfort during the treatment procedure.
- Erythema (Redness): The patient may show signs of mild redness in treated areas after treatment that will typically resolve within 48 hours.
- Edema (Swelling): The treatment area may show signs of mild swelling following treatment that will typically resolve within 48 hours.
- Nausea and drowsiness: Patients receiving electromagnetic stimulation on facial areas during treatment may experience nausea and drowsiness.

## Precautions

### Precautions for Patient

Consult with experts to decide whether treatment is appropriate for the following conditions:

- Epilepsy
  - Skin conditions caused by autoimmune diseases, skin cancer, and Herpes Simplex
  - Cardiovascular diseases such as heart attacks and strokes
- \*For other specific medical conditions, consult with your local doctor or practitioner.

### Precautions for Procedures

- Do not use the equipment without prior training, meeting qualifications or permission to operate by an authorized CLUEDERM representative.
- Immediately stop the procedure if any adverse events or system malfunctions occur during treatment.
- To prevent unauthorized use of the AQUAPURE, ensure access is limited strictly to authorized and trained personnel only.
- Have patients apply protective eyewear to avoid contact from PEEL+, SEBO+, REJUVE+, ampoule, and ultrasound gel during the AQUAPURE treatment. (Cotton pads are recommended)

### Precautions for System Safety

- Keep the surfaces of all hand-pieces clean after use.
- Do not use chemical agents such as benzene, acetone, or lacquer thinner for cleaning the AQUAPURE Hand-pieces.
- Observe for any scratches on the ELECTROPORATION Hand-piece when wiping and cleaning the applicator.
- If any of the hand-pieces have been dropped, replace individual applicators and inspect if they work properly so as to avoid any malfunction during treatment.

\*For additional information, refer to the AQUAPURE Maintenance Guide.

# Operational Guideline

## Graphical User Interface (GUI)

### AQUAPURE Main Interface

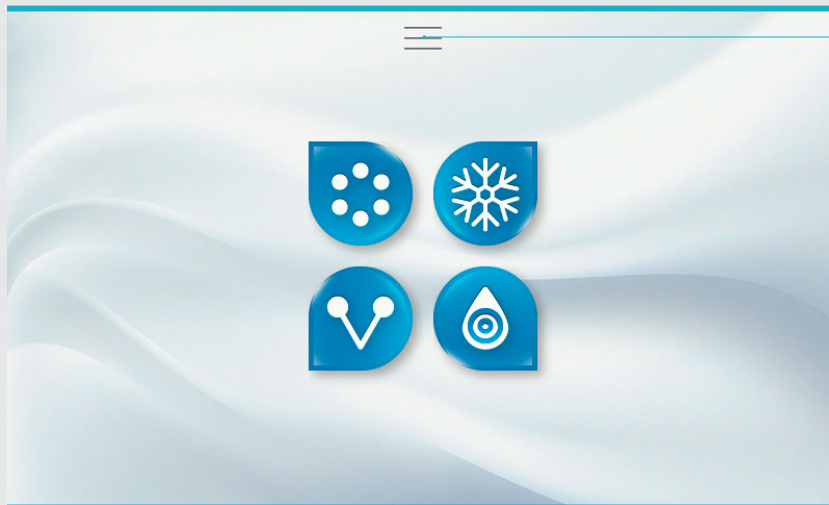

Menu Bar Icon  
for Settings

### AQUAPURE System Preferences

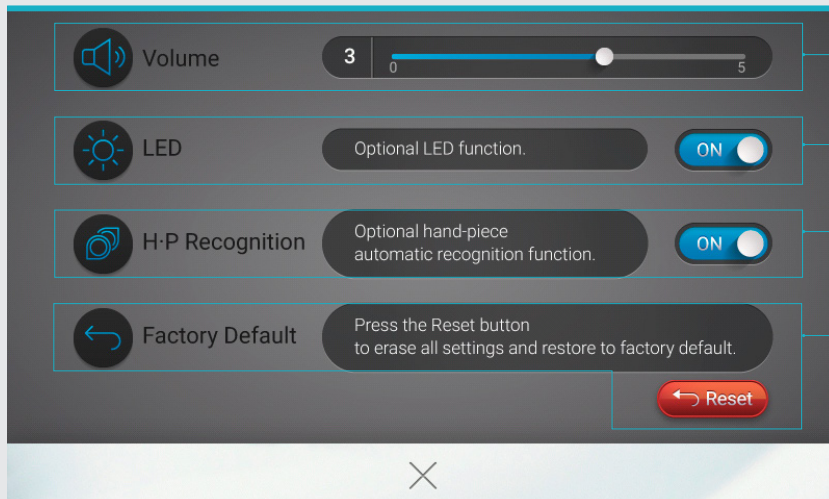

Volume  
Adjust from Levels 0-5

LED Function ON/OFF

Hand-piece Automatic  
Recognition Function  
ON/OFF

Reset Factory Default

# Operational Guideline

## Graphical User Interface (GUI)

### AQUAPURE Main Interface

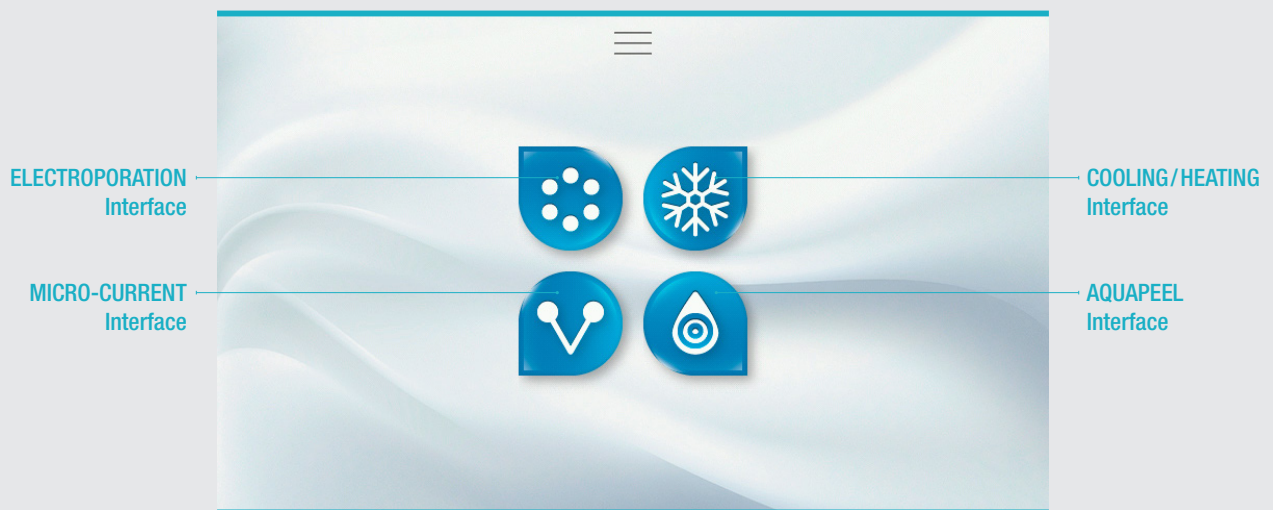

### COOLING/HEATING

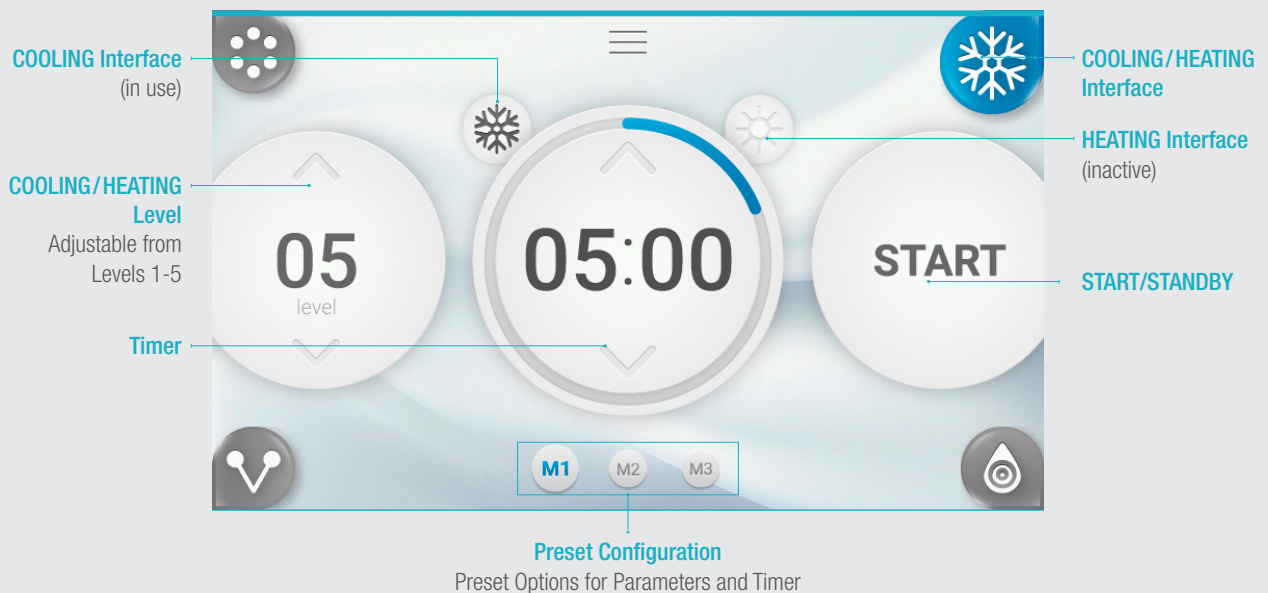

# Operational Guideline

## Graphical User Interface (GUI)

### AQUAPEEL (PEEL+ / SEBO+ / REJUVE+)

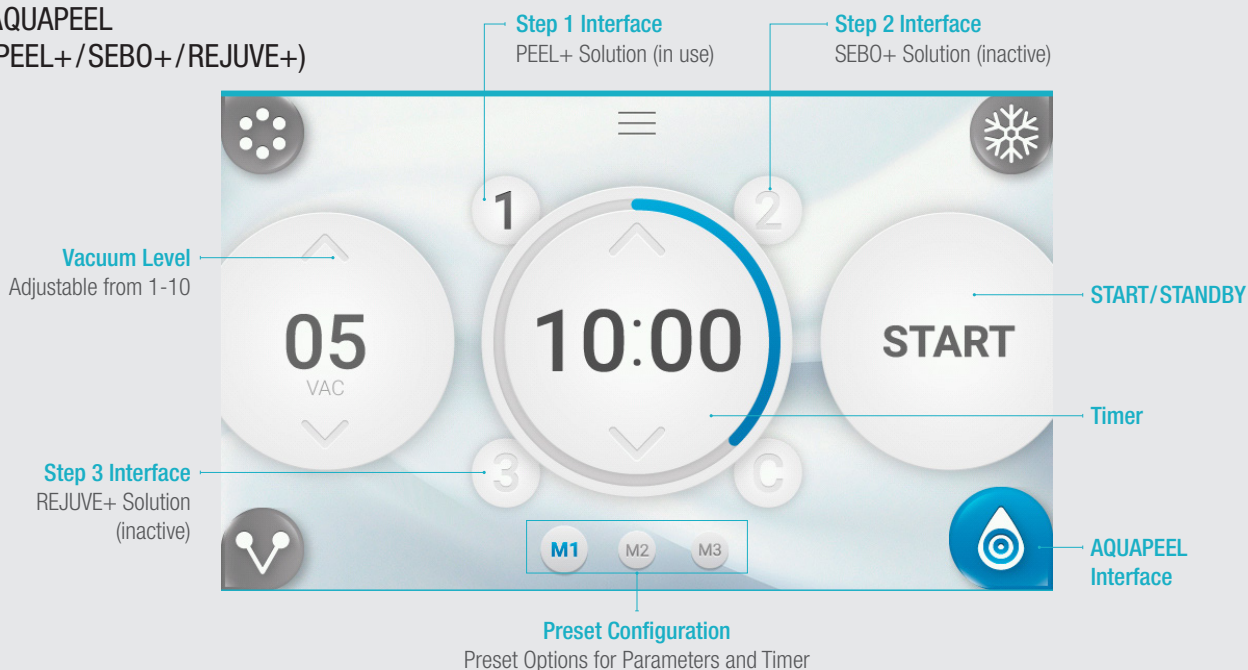

### AQUAPEEL (CLEANSYS)

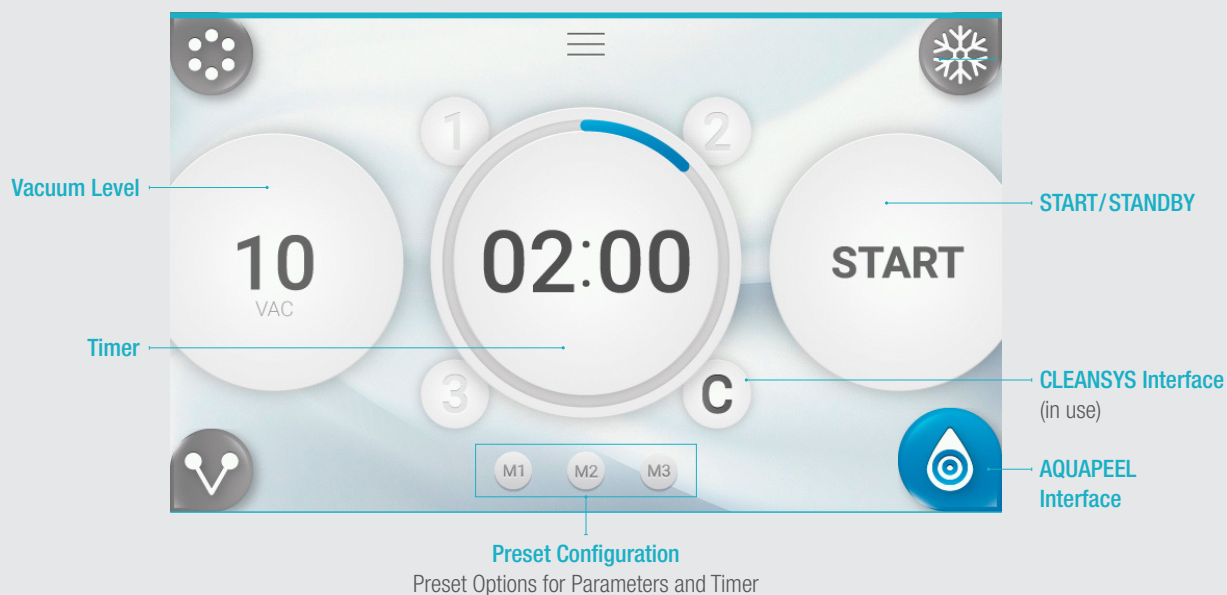



# Operational Guideline

## Graphical User Interface (GUI)

### ELECTROPORATION

The Electroporation GUI features a central display with three main circular controls: a level dial on the left showing '05 level', a central timer dial showing '10:00', and a 'START' button on the right. The interface includes several icons: a blue dot matrix icon in the top-left, a snowflake icon in the top-right, a water drop icon in the bottom-right, and a V-shaped icon in the bottom-left. A menu icon is centered at the top. At the bottom, there are three preset buttons labeled 'M1', 'M2', and 'M3'. Labels with arrows point to these elements: 'ELECTROPORATION Interface' (top-left icon), 'ELECTROPORATION Level Adjustable from 1-10' (left dial), 'START/STANDBY' (right button), 'Timer' (central dial), and 'Preset Configuration Preset Options for Parameters and Timer' (bottom buttons).

### MICRO-CURRENT

The Micro-Current GUI features a central display with three main circular controls: a level dial on the left showing '05 level', a central timer dial showing '10:00', and a 'START' button on the right. The interface includes several icons: a blue dot matrix icon in the top-left, a snowflake icon in the top-right, a water drop icon in the bottom-right, and a V-shaped icon in the bottom-left. A menu icon is centered at the top. At the bottom, there are three preset buttons labeled 'M1', 'M2', and 'M3'. Labels with arrows point to these elements: 'MICRO-CURRENT Level Adjustable from 1-10' (left dial), 'START/STANDBY' (right button), 'Timer' (central dial), and 'Preset Configuration Preset Options for Parameters and Timer' (bottom buttons).

# Treatment

## Preparation for Treatment



Latex Gloves



Ultrasound Gel



Ampoule



Tissues



Eye Protection

- There is no dress code for treatment. Comfortable attire is recommended.
- Patients must wear eye protection to avoid contact with PEEL+, SEBO+, REJUVE+, ampoule, and ultrasound gel during the AQUAPURE treatment. (Cotton pads are recommended)

\*Prior to procedure, have patients remove makeup or other facial applications by a thorough face wash to prevent obstruction of PEEL+, SEBO+, REJUVE+, ampoule, and ultrasound gel during the AQUAPURE treatment.

# Treatment

## Treatment Steps & Parameters

### AQUAPEEL : PEEL+/SEBO+

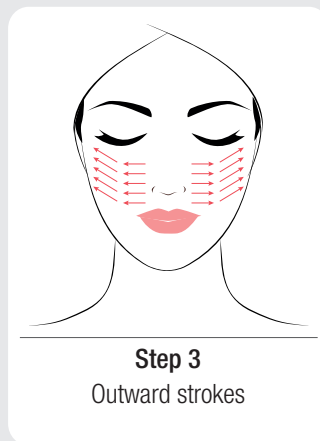
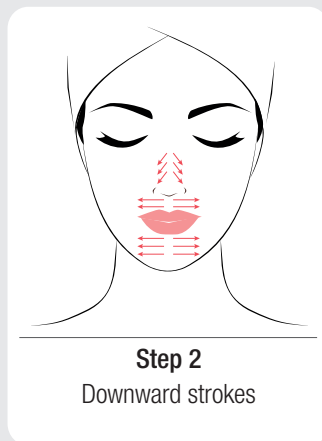

### 1. Conduct a test for solution distribution efficiency by adjusting the knob to maximum level (MAX)

- 1 Adjust the knob at the base of the AQUAPEEL Hand-piece counter-clockwise to maximum level (MAX).
- 2 Press "START" to activate the hand-piece.
- 3 Dab the hand-piece to latex gloves to check if distribution of the solution is consistent and stable in frequency prior to procedure.  
\*The recommended setting of solution distribution for each AQUAPEEL procedure is level 5.

### 2. Perform a peeling function with PEEL+/SEBO+

- 1 Press "1" (PEEL+) or "2" (SEBO+) on the AQUAPEEL Interface.
- 2 Adjust vacuum levels (recommended at 5-7).
- 3 Press "START" to activate AQUAPEEL Hand-piece and conduct gentle strokes on the face.
- 4 Gently rub the applied solution after each stroke.
- 5 Repeat treatment steps in remaining time of procedure (5 min.).  
\*Repeat procedure for Step 2 (SEBO+) on the AQUAPEEL interface.

### 3. Cleaning the AQUAPEEL with Cleaning Cap

- 1 Press "C" and insert Cleaning Cap on the AQUAPEEL Hand-piece.  
\*Clean the AQUAPEEL Hand-piece after completion of Step 2 (SEBO+) and Step 3 (REJUVE+).
- 2 Press "START" to activate AQUAPEEL Hand-piece and the cleaning procedure with CLEANSYS should begin (2 min.).

# Treatment

## AQUAPEEL : REJUVE+

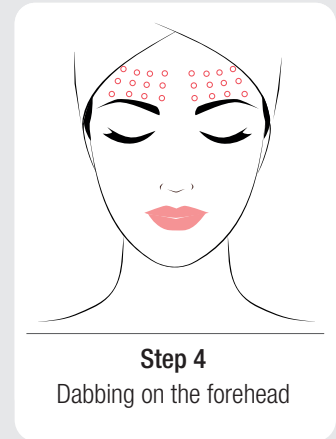
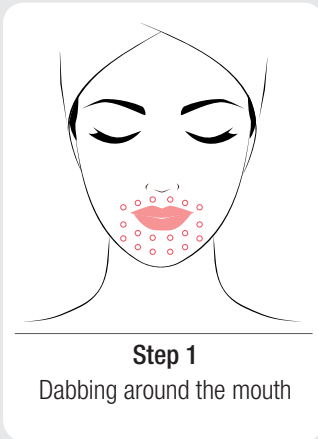

### 4. Hydrate with REJUVE+

- 1 Remove residues of PEEL+ and SEBO+ from the patient's face with a skin toner wipe.
- 2 Re-insert treatment tip after cleaning and press "3" on the AQUA PEEL Interface.
- 3 Adjust vacuum levels (recommended at 5-7).
- 4 Press "START" to activate AQUAPEEL hand-piece and dab the facial area.
- 5 Gently rub the applied solution after each dabbing pattern.
- 6 Repeat dabbing treated area in remaining time of procedure (5 min.).

## ELECTROPORATION

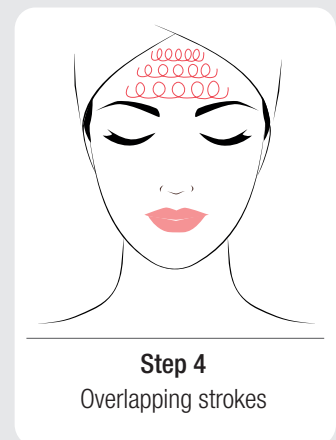
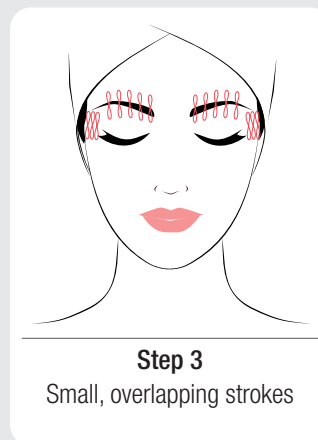
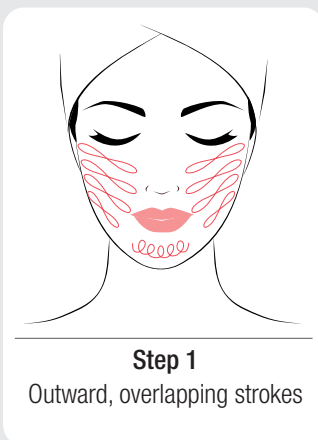

### 5. Treat the facial area with ELECTROPORATION

- 1 Use any ampoule as an agent between the hand-piece and skin during procedure.
- 2 Adjust levels (recommended at 3-4).
- 3 Press "START" to activate ELECTROPORATION Hand-piece and gently stroke the facial area.
- 4 Repeat treatment steps in remaining time of procedure (5 min.).

## MICRO-CURRENT

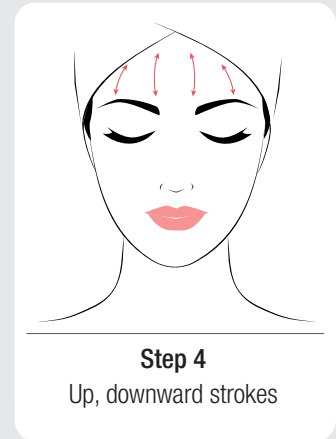
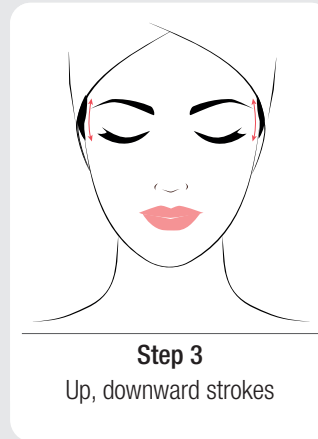
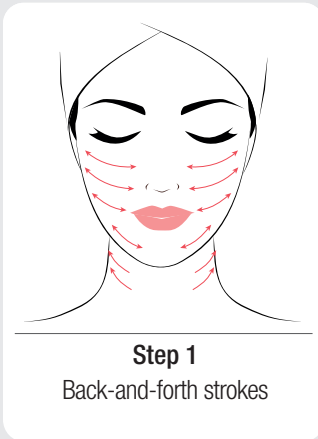

### 6. Treat the facial area with MICRO-CURRENT

- 1 Use ampoule or ultrasound gel as an agent between the hand-piece and skin during procedure.
- 2 Adjust levels (recommended at 3-4).
- 3 Press "START" to activate MICRO-CURRENT Hand-piece and gently stroke the facial area.
- 4 Repeat treatment steps in remaining time of procedure (5 min.).

## COOLING/HEATING

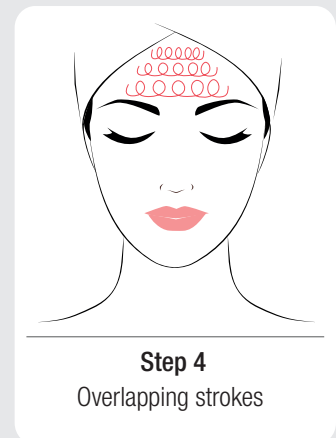
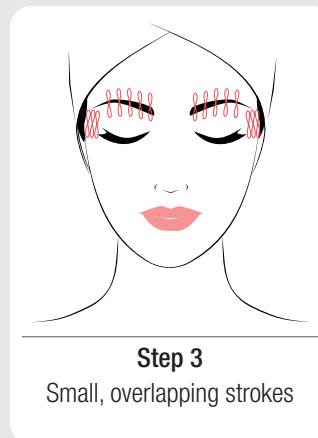
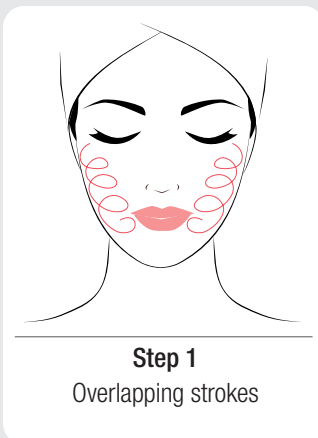

### 7. Completing the treatment with COOLING/HEATING

- 1 Use ampoule or ultrasound gel as an agent between the hand-piece and skin during procedure.
  - 2 Press "COOLING" or "HEATING" on the COOLING/HEATING Interface.
  - 3 Adjust "COOLING" or "HEATING" levels.
  - 4 Press "START" to activate COOLING/HEATING Hand-piece and gently stroke the facial area.
  - 5 Repeat treatment steps in remaining time of procedure (5 min. per each function).
- \*Practitioners performing the COOLING/HEATING procedure can start the procedure with either COOLING or HEATING.

